

HIGH AMPERAGE / HEAVY DUTY ALTERNATORS / CHARGING SYSTEMS



PX-2T-120 or 130



PX-2R-120 or 130



PX-2P-120 or 130

3" FOOT (PX-2P-2 HAS A 2" FOOT)

120/102 AMPS

PX-2-120 SERIES - TESTED AND PROVEN		
ROTOR RPM	AMPS @ 27.5 VOLTS	
	COLD (SAE)	HOT (200°F)
2000	50	43
2250	65	55
2500	80	68
2750	90	77
3000	95	81
3500	105	89
4000	110	94
4500	115	98
5000	120	102

130/111 AMPS

PX-2-130 SERIES - TESTED AND PROVEN		
ROTOR RPM	AMPS @ 27.5 VOLTS	
	COLD (SAE)	HOT (200°F)
2000	25	21
2250	45	38
2500	65	55
2750	85	72
3000	95	81
3500	115	98
4000	120	102
4500	125	106
5000	130	111



PX-4024 28-VOLT REGULATOR



DUAL V-BELT PULLEYS ARE ALSO AVAILABLE

APPLICATIONS

- Transit Buses, Motorcoaches and Heavy-duty Industrial Equipment, EMS/Fire/Ambulance.
- Commercial Trucking/Refrigeration, Lift Trucks and Material Handling.
- Contact PennTex for more information.

OPTIONS

- A variety of case mount styles, 6 & 8-groove serpentine and V-belt-style pulleys are available.



28-Volt PX-2 Dimensions

Special Features

- 1) Dual 5/16" positive output posts.
- 2) Heavy duty hand wound high output stator.
- 3) Heavy duty dual plane balanced rotor.
- 4) Heavy duty long life brushes.
- 5) Heat sinks designed for efficient cooling.
- 6) Heavy Duty bearings with high temperature seals and grease.
- 7) Twelve (12) press fit 60 amp diodes.
- 8) Specially designed heavy duty 28-volt regulator that produces higher output ratings; runs cooler than current industry standards.
- 9) Regulator has ground fault and high voltage protection.
- 10) GXL wire is standard in all harnesses.
- 11) Weight: Approximately 25 pounds.

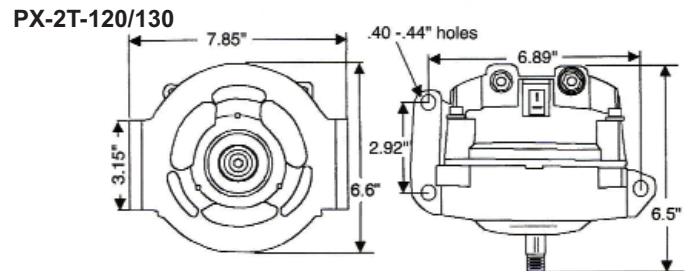
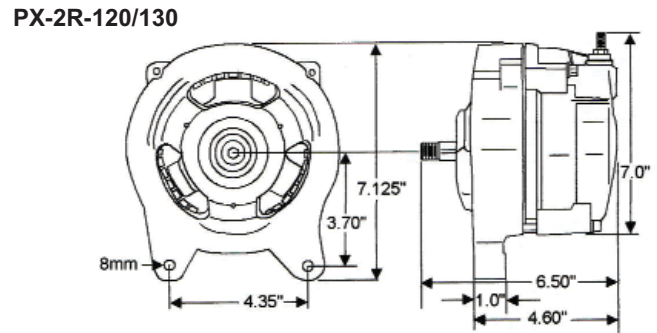
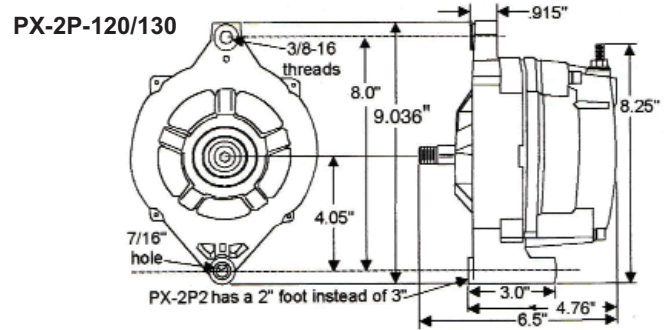

PennTex Industries recommends using a minimum of 2 gauge battery and ground cable. For maximum performance route 2 gauge battery cable or larger from the alternator battery post directly to the battery positive stud. The ground cable from the alternator should also be a minimum of 2 gauge cable and should be bolted directly to a chassis ground or the negative side of the battery.

WARRANTY

PENNTEx INDUSTRIES, INC. STANDARD WARRANTY IS EIGHTEEN (18) MONTHS OR 75,000 MILES – WHICHEVER OCCURS FIRST, WHEN INSTALLED ON A NEW OEM VEHICLE. AFTERMARKET INSTALLATIONS HAVE A WARRANTY OF TWELVE (12) MONTHS/UNLIMITED MILES.

PERFORMANCE ENDURANCE AND SATISFACTION

PennTex
INDUSTRIES, INC.

Manufacturers of
High Efficiency Alternators and
Mobile Electronic Devices.

Corporate:
202 Plaza Drive
Manchester, PA 17345
Ph: 717/266-8762
Fax: 717/266-7803

www.penntexusa.com
E Mail: sales@penntexusa.com

Manufacturing:
7620 Flagstone Drive
Fort Worth, TX 76118
Ph: 817/590-2818
Toll Free: 877/590-7366
Fax: 817/590-0505

