

INSTALLATION INSTRUCTIONS

REAR BEARING INSTALLATION TOOL (PX-2534)

NOTE: The procedures below are used with model PX-2, PX-4, and PX-5 series alternators. This tool is used only on the rear bearing of PennTex alternators that use a C-ring (snap-ring) to retain the rear bearing. This tool is not used on PennTex alternators with a 3-screw rear bearing retainer plate.

Each rear bearing installation kit should contain three pieces:

- A:** Rear Bearing Alignment Tool (this tool can also be used to press the rotor out during disassembly)
- B:** PX-2 and PX-4 Rear Bearing Press Tool
- C:** PX-5 Rear Bearing Press Tool

INSTALLATION PROCEDURES:

1. This tool properly positions the bearing in the rear case. The rear bearing is the second-to-last part installed during assembly of the alternator. It is pressed in from the back of the alternator.
2. Determine which bearing press tool ("B" or "C") you will use by looking on the PennTex alternator ID tag riveted to the front alternator housing. The alternator Model Number is stamped there. Use tool "B" with model PX-2 & PX-4 PennTex alternators that use a C-ring rear bearing retainer. Use tool "C" with model PX-5 PennTex alternators that use a C-ring rear bearing retainer. Use tool "A" with both. If no tag is present, use the stator width as the determining factor. If the stator is barely visible between the two cases (indicating a PX-2 or PX-4), use tool "B". If more than an inch of stator is visible between the cases (indicating a PX-5), use tool "C".
3. Place the alternator with the pulley facing down on a suitable bearing press. Insert the rear bearing wave washer into the rear housing cavity until it goes to the bottom of the cavity. Start the rear bearing, by hand, into the rear housing bearing cavity and onto the rotor shaft.
4. Use bearing alignment tool "A" with the proper bearing press tool ("B" or "C") and press the bearing into the cavity until tool "A" bottoms out against the rotor shaft.
5. Tighten all through bolts. **NOTE:** Do not retighten the through bolts after procedure # 5.
6. Remove bearing alignment tool ("A") from the assembly and continue to press the rear bearing until the bearing press tool ("B" or "C") bottoms out against the outer flange of the bearing cavity. **DO NOT OVER PRESS.**
7. Install the rear bearing C-ring.

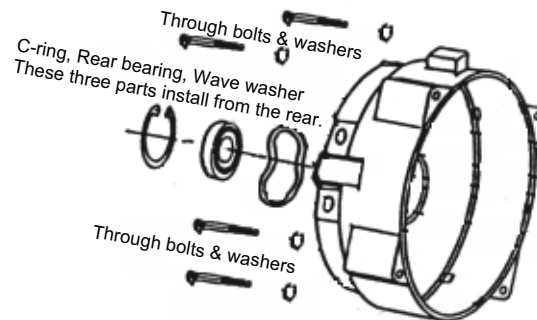
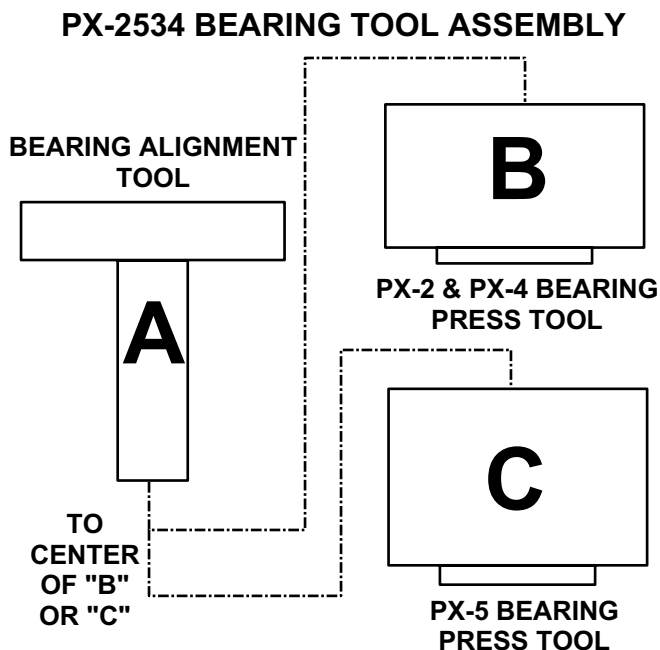

REAR HOUSING USED FOR ILLUSTRATION ONLY. ALTERNATOR SHOULD BE COMPLETELY ASSEMBLED EXCEPT FOR WAVE WASHER, BEARING, & C-RING. THESE ARE THE LAST THREE PARTS INSTALLED WHEN BUILDING A PENNTEX ALTERNATOR.