

NOTE: PX-317S IS THE PART NUMBER FOR A COMPLETE ALTERNATOR, REGULATOR AND HARNESS KIT.

PX-3S-175 IS THE ALTERNATOR ONLY PART NUMBER. THIS NUMBERING SYSTEM IS THE SAME WITH ALL MODELS OF PENNTEX KITS AND ALTERNATORS: PX-220/PX-2, PX-420/PX-4, PX-520/PX-5, ETC.

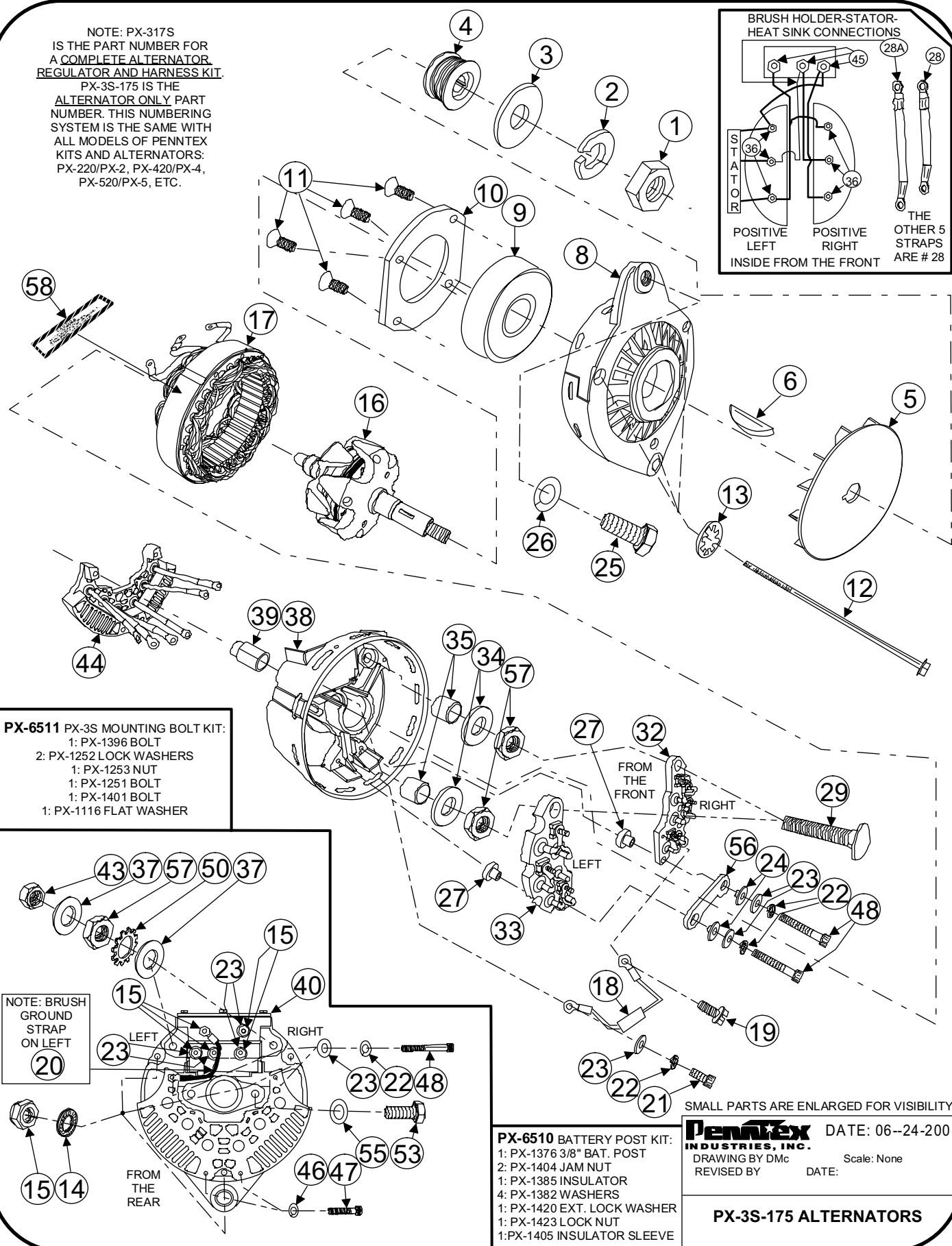

PX-6511 PX-3S MOUNTING BOLT KIT:
1: PX-1396 BOLT
2: PX-1252 LOCK WASHERS
1: PX-1253 NUT
1: PX-1251 BOLT
1: PX-1401 BOLT
1: PX-1116 FLAT WASHER

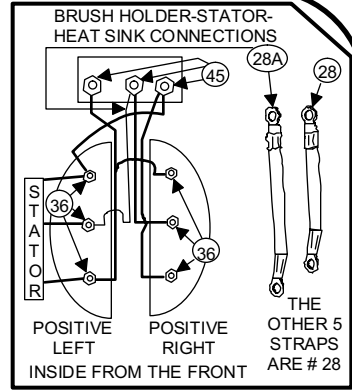
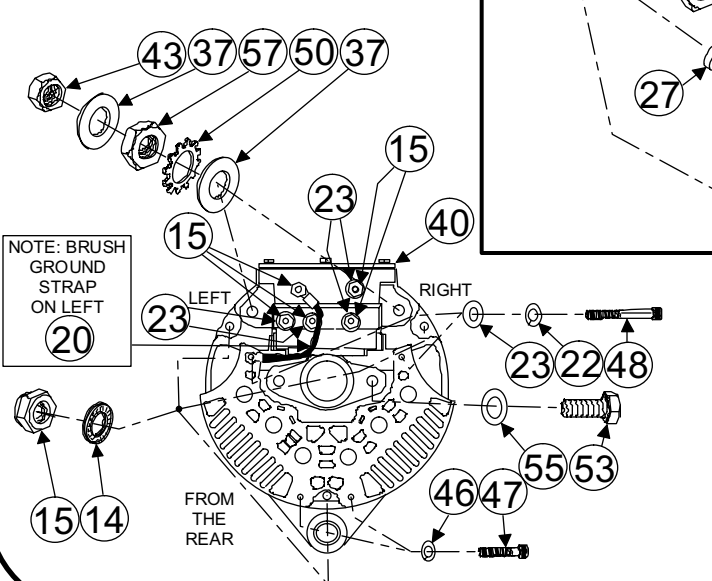

PX-6510 BATTERY POST KIT:
1: PX-1376 3/8" BAT. POST
2: PX-1404 JAM NUT
1: PX-1385 INSULATOR
4: PX-1382 WASHERS
1: PX-1420 EXT. LOCK WASHER
1: PX-1423 LOCK NUT
1: PX-1405 INSULATOR SLEEVE

SMALL PARTS ARE ENLARGED FOR VISIBILITY

PennTex INDUSTRIES, INC. DATE: 06--24-2008
DRAWING BY Dmc Scale: None
REVISED BY DATE:

PX-3S-175 ALTERNATORS

PX-3S-175 (28 VOLT)**PARTS LIST**

All



No.	Part #	Description	Qty.
1	PX-1083	Nut, Rotor	1
2	PX-1059	Washer, Rotor Lock	1
3	PX-1058	Spacer, Fan	1
4	PA-4024	Pulley, 2.25 K8 No Boss LB	1
5	PX-1409	Fan, Cooling (PX3&6)	1
6	PX-1080	Key, Woodruff (PX3&6)	1
8	PX-1073	Housing, Front (PX3&6)	1
9	PX-1074	Bearing, Front (PX2/3/4G/5)	1
10	PX-1075	Retainer, Bearing (PX3&6)	1
11	PX-1301	Screw, Front Bearing Retainer	4
12	PX-1092	Bolt, Thru	3
13	PX-1101	Washer, #10 Internal Lock	3
14	PX-1269	Washer, #10 Nord Locking	3
15	PX-1213	Nut, 10-32 Nylon Lock	8
16	PA-4215	Rotor, 28 Volt	1
17	PA-4444	Stator, 28V 175A (PX3) DD	1
18	PX-3514	Capacitor Assembly (PX3)	1
19	PX-1096	Screw, 8-32x3/8" Hex	1
20	PX-3100	Strap, Brush Holder Ground	1
21	PX-1303	Screw, 10-32x1/2 SHC	1
22	PX-1100	Washer, #10 Lock	5
23	PX-1111	Washer, #10 Flat	9
24	PX-1091	Insulator, Shoulder (PX3&6)	2
25	PX-1251	Bolt, 1/2x13x1" Hex Gr 8	1
26	PX-1252	Washer, 1/2 Split Lock Gr 8	1
27	PX-1090	Insulator, Positive Heat Sink	2
28	PX-3510	Strap, Rectifier A/C (PX3&6)	5
28A	PX-3510L	Strap, Rectifier A/C Long (PX3&6)	1
29	PX-1376	Battery Post, 3/8x2-1/2" (PX3)	2
32	PX-6504	Heat Sink Asm, Pos R (PX3)	1
33	PX-3504	Heat Sink Asm, Pos L (PX3)	1
34	PX-1385	Insulator, Heat Sink 3/8" (PX3)	2
35	PX-1405	Sleeve, 3/8" Battery Post (PX3)	2
36	PX-1099	Nut, 8-32 Keps	6
37	PX-1382	Washer, 3/8" Flat (PX3&6)	4
38	PX-1375	Housing, Rear PX3&6)	1
39	PX-1081	Bearing, Rear (INA)	1
40	PX-3517	Brush Assembly, New (PX3&6)	1
43	PX-1423	Nut, 3/8" Steel Lock	2
44	PX-6506	Heat Sink Asm, Neg Ext (PX3)	1

No.	Part #	Description	Qty.
45	PX-1113	Nut, 10-32 Keps	3
46	PX-1104	Washer, 1/4" Lock	2
47	PX-1380	Bolt, 1/4-20x1-1/2" SHC	2
48	PX-1377	Screw, 10-32x1-1/4" SHC	4
50	PX-1420	Washer, 3/8" External Lock	2
53	PX-1401	Screw, 5/16x3/4" Cap	1
55	PX-1116	Washer, 5/16" Flat	1
56	PX-1386	Strap, Positive Heat Sink	1
57	PX-1404	Nut, 3/8" Steel Jam	4
58	PX-1387	Decal, Caution (PX3&6)	1
***	PX-6510	Battery Post Kit	2
***	PX-6511	Mounting Bolt Kit (PX3S)	1
***	PX-3513	Hsg Asm, Rear W/O Stator	1
***		Not Shown In Drawing	
		NOTE: A 28 Volt PX-3S-175 uses a PX-4024 Voltage Regulator and a PX-3502-3 Harness.	
		Contact Us: Phone: 817-590-2818 Fax: 817-590-0505 web: www.penntexusa.com email: sales@penntexusa.com	
		PennTex 05-20-2009	

NOTE: PX-320S IS THE PART NUMBER FOR A COMPLETE ALTERNATOR, REGULATOR AND HARNESS KIT.

PX-3S-200 IS THE ALTERNATOR ONLY PART NUMBER. THIS NUMBERING SYSTEM IS THE SAME WITH ALL MODELS OF PENNTEX KITS AND ALTERNATORS: PX-220/PX-2, PX-420/PX-4, PX-520/PX-5, ETC.

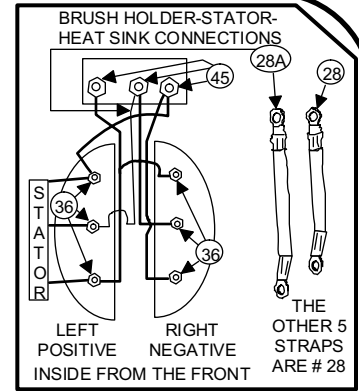

NOTE: PART # 7 IS OBSOLETE. IT HAS BEEN COMBINED WITH PART # 5.

NOTE: VERY EARLY PX-3 BATTERY POSTS WERE 5/16" IN DIAMETER INSTEAD OF 3/8". PARTS LIST AT LEFT.

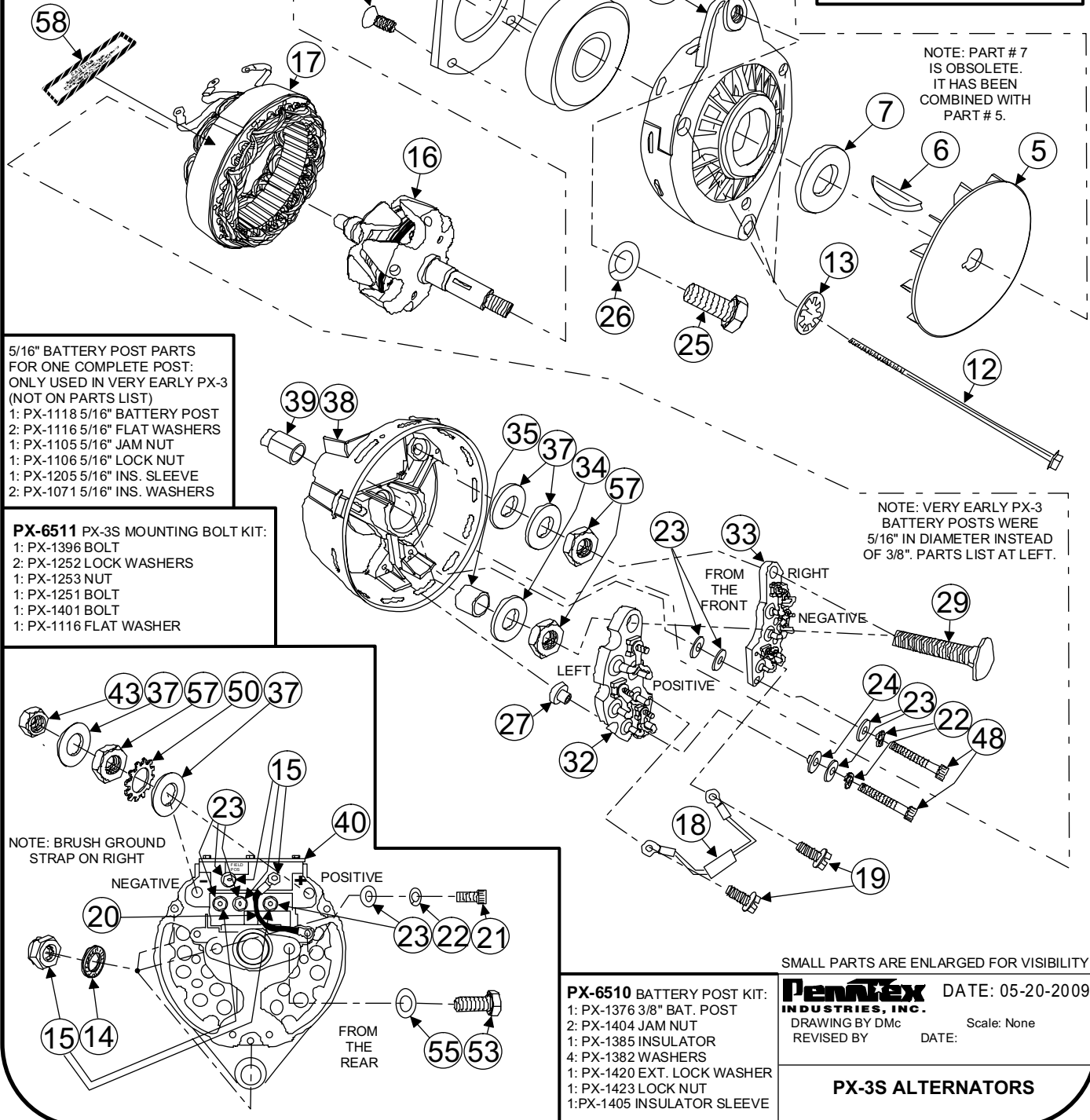

5/16" BATTERY POST PARTS FOR ONE COMPLETE POST: ONLY USED IN VERY EARLY PX-3 (NOT ON PARTS LIST)

- 1: PX-1118 5/16" BATTERY POST
- 2: PX-1116 5/16" FLAT WASHERS
- 1: PX-1105 5/16" JAM NUT
- 1: PX-1106 5/16" LOCK NUT
- 1: PX-1205 5/16" INS. SLEEVE
- 2: PX-1071 5/16" INS. WASHERS

PX-6511 PX-3S MOUNTING BOLT KIT:

- 1: PX-1396 BOLT
- 2: PX-1252 LOCK WASHERS
- 1: PX-1253 NUT
- 1: PX-1251 BOLT
- 1: PX-1401 BOLT
- 1: PX-1116 FLAT WASHER

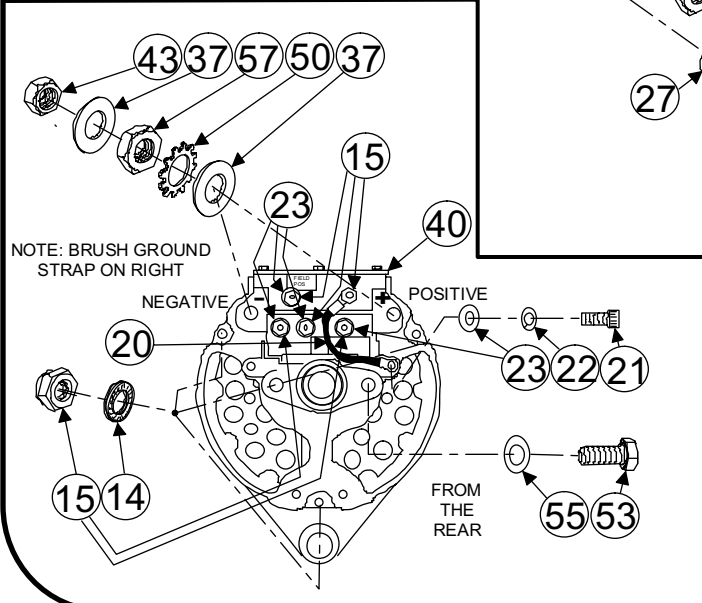

SMALL PARTS ARE ENLARGED FOR VISIBILITY

PX-6510 BATTERY POST KIT:

- 1: PX-1376 3/8" BAT. POST
- 2: PX-1404 JAM NUT
- 1: PX-1385 INSULATOR
- 4: PX-1382 WASHERS
- 1: PX-1420 EXT. LOCK WASHER
- 1: PX-1423 LOCK NUT
- 1: PX-1405 INSULATOR SLEEVE

Penntex INDUSTRIES, INC. DATE: 05-20-2009

DRAWING BY DMC Scale: None

REVISED BY DATE:

PX-3S ALTERNATORS

PX-3S-200**PARTS LIST**

0395029 to 100235241



No.	Part #	Description	Qty.
1	PX-1083	Nut, Rotor	1
2	PX-1059	Washer, Rotor Lock	1
3	PX-1058	Spacer, Fan	1
4	PX-1355	Pulley, 2.5 K8 LB (PX3&6)	1
5	PX-1409	Fan, Cooling (PX3&6)	1
6	PX-1080	Key, Woodruff (PX3&6)	1
7	none	Spacer, Fan (Now Part Of #5)	0
8	PX-1073	Housing, Front (PX3&6)	1
9	PX-1074	Bearing, Front	1
10	PX-1075	Retainer, Bearing (PX3&6)	1
11	PX-1301	Screw, Front Bearing Retainer	4
12	PX-1364	Bolt, Thru	3
13	PX-1101	Washer, #10 Internal Lock	3
14	PX-1269	Washer, #10 Nord Locking	3
15	PX-1213	Nut, 10-32 Nylon Lock	8
16	PX-1077	Rotor, 14V (PX3)	1
17	PX-3503-1	Stator, 14V, 200 Amp (PX3)	1
18	PX-3514	Capacitor Assembly (PX3)	1
19	PX-1096	Screw, 8-32x3/8" Hex	2
20	PX-3100	Strap, Brush Holder Ground	1
21	PX-1303	Screw, 10-32x1/2" SHC	1
22	PX-1100	Washer, #10 Lock	3
23	PX-1111	Washer, #10 Flat	9
24	PX-1091	Insulator, Shoulder (PX3&6)	1
25	PX-1251	Bolt, 1/2x13x1" Hex Gr 8	1
26	PX-1252	Washer, 1/2" Split Lock Gr 8	1
27	PX-1090	Insulator, Positive Heat Sink	1
28	PX-3510	Strap, Rectifier A/C (PX3&6)	5
28A	PX-3510L	Strap, Rectifier Long (PX3&6)	1
29	PX-1376	Battery Post, 3/8x2-1/2" (PX3)	2
32	PX-3504	Heat Sink Asm, Pos L (PX3)	1
33	PX-3505	Heat Sink Asm, Neg R (PX3)	1
34	PX-1385	Insulator, Heat Sink 3/8" (PX3)	2
35	PX-1405	Sleeve, 3/8" Battery Post (PX3)	1
36	PX-1099	Nut, 8-32 Keps	6
37	PX-1382	Washer, 3/8" Flat	6
38	PX-1375	Housing, Rear (PX3&6 3/8")	1
39	PX-1081	Bearing, Rear (INA)	1
40	PX-3517	Brush Assembly, New (PX3&6)	1
43	PX-1423	Nut, 3/8" Steel Lock (PX3&6)	2

No.	Part #	Description	Qty.
45	PX-1113	Nut, 10-32 Keps	5
48	PX-1114	Screw, 10-32x1" SHC	2
50	PX-1420	Washer, 3/8" Ext Lock (PX3)	2
53	PX-1401	Screw, 5/16x3/4" Hex Cap	1
55	PX-1116	Washer, 5/16" Flat	1
57	PX-1404	Nut, 3/8" Steel Jam (PX3&6)	4
58	PX-1387	Decal, Caution (PX3&6)	1
***	PX-6510	Battery Post Assembly (PX3)	2
		NOTE: includes parts used on either a positive or negative post. See parts breakdown for proper parts useage.	
		NOTE: some very early PX3 models used 5/16" bat. posts. A parts list for them is on the left side of the parts drawing.	
***	PX-6511	Kit, Mounting Bolt (PX3S)	1
***	PX-3535	Housing Asm,Rear W/O Stator (complete rear housing with all parts except stator. This assembly has 3/8" bat. posts.)	1
***		Not Shown In Drawing	
		Contact Us: Phone: 817-590-2818 Fax: 817-590-0505 web: www.penntexusa.com email: sales@penntexusa.com	
		PennTex 05-20-2009	

NOTE: PX-320S OR PX-325S IS THE PART NUMBER FOR A COMPLETE ALTERNATOR, REGULATOR AND HARNESS KIT. PX-3S-200 OR PX-3S-250 IS THE ALTERNATOR ONLY PART NUMBER. THIS NUMBERING SYSTEM IS THE SAME WITH ALL MODELS OF PENNTEX KITS AND ALTERNATORS: PX-220/PX-2, PX-420/PX-4, PX-520/PX-5, ETC.

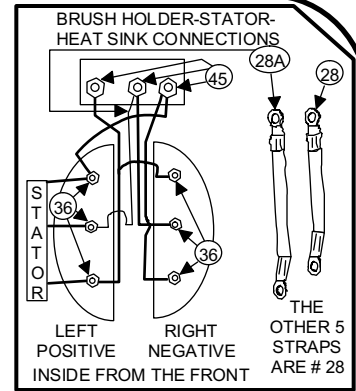

NOTE: PART # 7 IS OBSOLETE. IT HAS BEEN COMBINED WITH PART # 5.

NOTE: PX-3 ALTERNATORS MADE DURING THIS PERIOD ALL HAD 3/8" BATTERY POSTS.

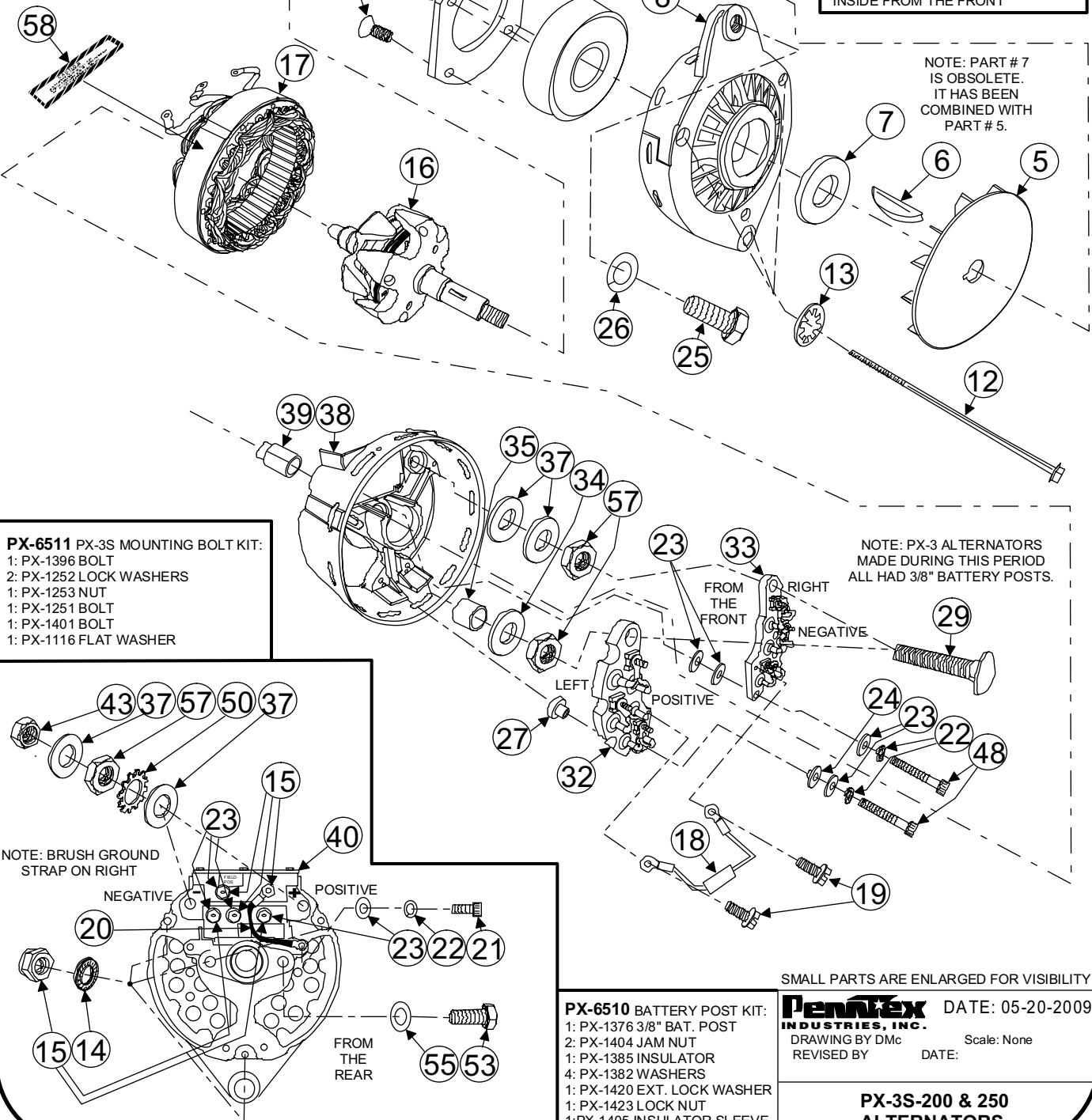

- PX-6511 PX-3S MOUNTING BOLT KIT:**
- 1: PX-1396 BOLT
 - 2: PX-1252 LOCK WASHERS
 - 1: PX-1253 NUT
 - 1: PX-1251 BOLT
 - 1: PX-1401 BOLT
 - 1: PX-1116 FLAT WASHER

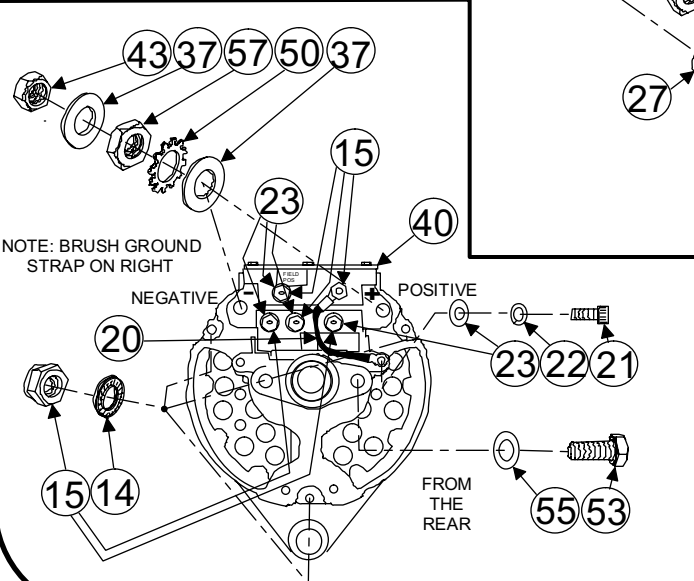

- PX-6510 BATTERY POST KIT:**
- 1: PX-1376 3/8" BAT. POST
 - 2: PX-1404 JAM NUT
 - 1: PX-1385 INSULATOR
 - 4: PX-1382 WASHERS
 - 1: PX-1420 EXT. LOCK WASHER
 - 1: PX-1423 LOCK NUT
 - 1: PX-1405 INSULATOR SLEEVE

SMALL PARTS ARE ENLARGED FOR VISIBILITY

Penntex INDUSTRIES, INC. DATE: 05-20-2009
DRAWING BY DMc Scale: None
REVISED BY DATE:

PX-3S-200 & 250 ALTERNATORS

NOTE: PX-328S IS THE PART NUMBER FOR A COMPLETE ALTERNATOR, REGULATOR AND HARNESS KIT.

PX-3S-285 IS THE ALTERNATOR ONLY PART NUMBER. THIS NUMBERING SYSTEM IS THE SAME WITH ALL MODELS OF PENNTEX KITS AND ALTERNATORS: PX-220/PX-2, PX-420/PX-4, PX-520/PX-5, ETC.

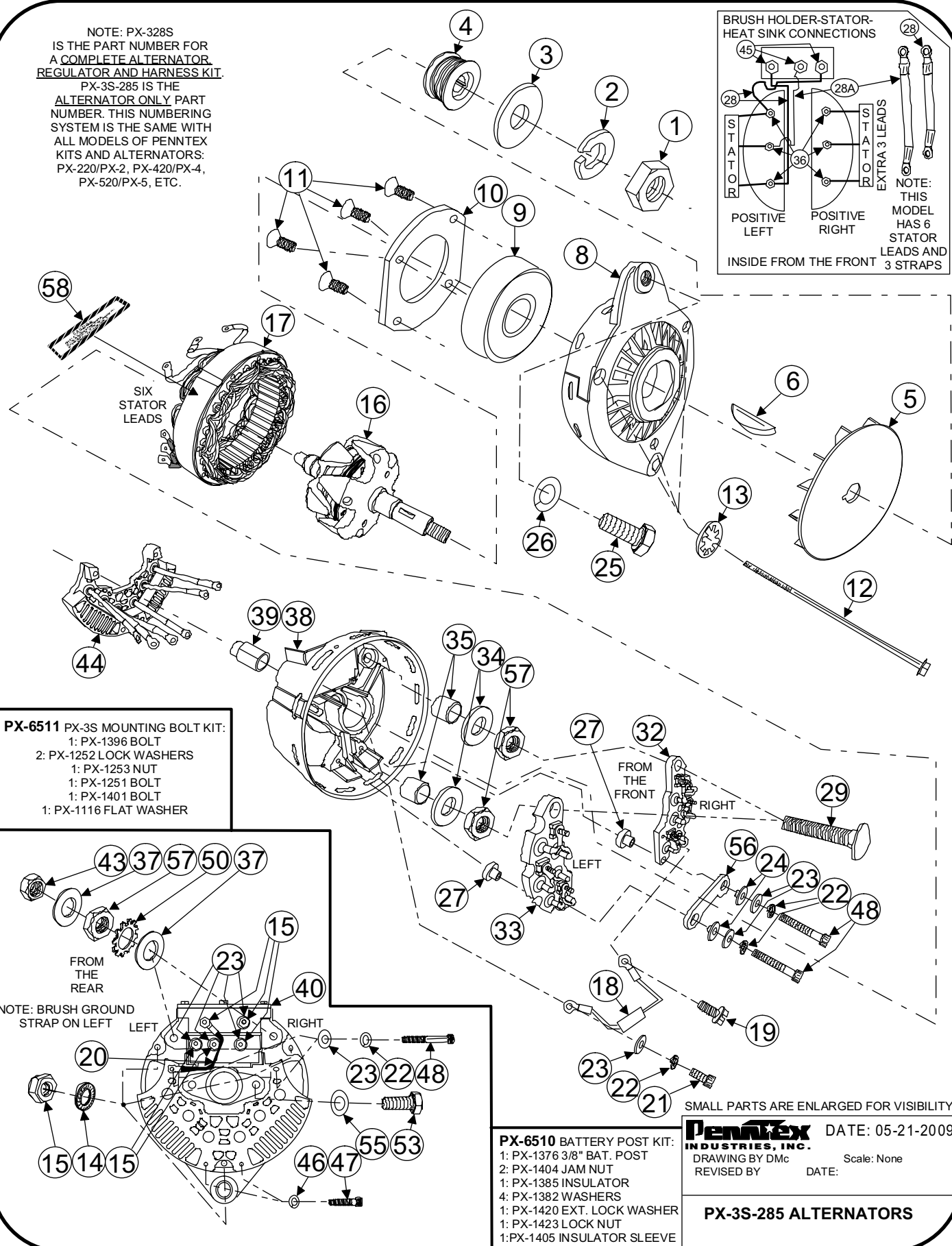
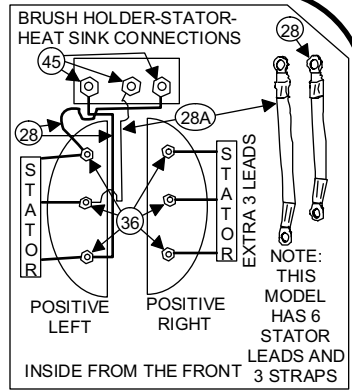

- PX-6511 PX-3S MOUNTING BOLT KIT:**
- 1: PX-1396 BOLT
 - 2: PX-1252 LOCK WASHERS
 - 1: PX-1253 NUT
 - 1: PX-1251 BOLT
 - 1: PX-1401 BOLT
 - 1: PX-1116 FLAT WASHER

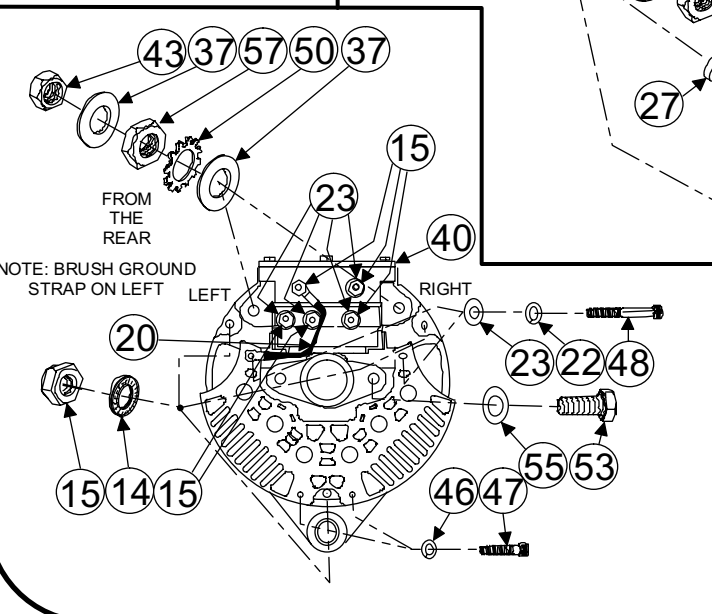

- PX-6510 BATTERY POST KIT:**
- 1: PX-1376 3/8" BAT. POST
 - 2: PX-1404 JAM NUT
 - 1: PX-1385 INSULATOR
 - 4: PX-1382 WASHERS
 - 1: PX-1420 EXT. LOCK WASHER
 - 1: PX-1423 LOCK NUT
 - 1: PX-1405 INSULATOR SLEEVE

SMALL PARTS ARE ENLARGED FOR VISIBILITY

PennTex INDUSTRIES, INC. DATE: 05-21-2009
DRAWING BY Dmc Scale: None
REVISED BY DATE:

PX-3S-285 ALTERNATORS

PX-3S-285**PARTS LIST**

All



No.	Part #	Description	Qty.
1	PX-1083	Nut, Rotor	1
2	PX-1059	Washer, Rotor Lock	1
3	PX-1058	Spacer, Fan	1
4	PX-1355	Pulley, 2.5 K8 LB (PX3)	1
5	PX-1409	Fan, Cooling (PX3&6)	1
6	PX-1080	Key, Woodruff (PX3&6)	1
8	PX-1073	Housing, Front (PX3&6)	1
9	PX-1074	Bearing, Front (PX2/3/4G/5)	1
10	PX-1075	Retainer, Bearing (PX3&6)	1
11	PX-1301	Screw, Front Bearing Retainer	4
12	PX-1092	Bolt, Thru (PX3)	3
13	PX-1101	Washer, #10 Internal Lock	3
14	PX-1269	Washer, #10 Nord Locking	3
15	PX-1213	Nut, 10-32 Nylon Lock	8
16	PX-1077	Rotor, 14V	1
17	PX-5541	Stator, 14V 285A (PX3)	1
18	PX-3514	Capacitor Assembly (PX3)	1
19	PX-1096	Screw, 8-32x3/8" Hex	1
20	PX-3100	Strap, Brush Holder Ground	1
21	PX-1303	Screw, 10-32x1/2" SHC	1
22	PX-1100	Washer, #10 Lock	5
23	PX-1111	Washer, #10 Flat	9
24	PX-1091	Insulator, Shoulder (PX3&6)	2
25	PX-1251	Bolt, 1/2x13x1" Hex Gr 8	1
26	PX-1252	Washer, 1/2" Split Lock Gr 8	1
27	PX-1090	Insulator, Positive Heat Sink	2
28	PX-3510	Strap, Rectifier A/C (PX3&6)	2
28A	PX-3510L	Strap, Rectifier A/C Long (PX3&6)	1
29	PX-1376	Battery Post, 3/8x2-1/2" (PX3)	2
32	PX-6504	Heat Sink Asm, Pos R (PX3)	1
33	PX-3504	Heat Sink Asm, Pos L (PX3)	1
34	PX-1385	Insulator, Heat Sink 3/8" (PX3)	2
35	PX-1405	Sleeve, 3/8" Battery Post (PX3)	2
36	PX-1099	Nut, 8-32 Keps	6
37	PX-1382	Washer, 3/8" Flat (PX3&6)	4
38	PX-1375	Housing, Rear (PX3&6)	1
39	PX-1081	Bearing, Rear (INA)	1
40	PX-3517	Brush Assembly, New (PX3&6)	1
43	PX-1423	Nut, 3/8" Steel Lock	2
44	PX-6506	Heat Sink Asm, Neg Ext (PX3)	1

No.	Part #	Description	Qty.
45	PX-1113	Nut, 10-32 Keps	3
46	PX-1104	Washer, 1/4" Lock	2
47	PX-1380	Bolt, 1/4-20x1-1/2" SHC	2
48	PX-1377	Screw, 10-32x1-1/4" SHC	4
50	PX-1420	Washer, 3/8" External Lock	2
53	PX-1401	Screw, 5/16x3/4" Cap	1
55	PX-1116	Washer, 5/16" Flat	1
56	PX-1386	Strap, Positive Heat Sink	1
57	PX-1404	Nut, 3/8" Steel Jam	4
58	PX-1387	Decal, Caution (PX3&6)	1
***	PX-6510	Battery Post Kit	2
***	PX-6511	Mounting Bolt Kit (PX3S)	1
***	PX-3513	Hsg Asm, Rear W/O Stator	1
***		Not Shown In Drawing	
		NOTE: A PX-3S-285 uses a PX-4000 Voltage Regulator and a PX-3502-3 Harness.	
		Contact Us: Phone: 817-590-2818 Fax: 817-590-0505 web: www.penntexusa.com email: sales@penntexusa.com	
		PennTex 05-19-2009	

NOTE: PX-330S IS THE PART NUMBER FOR A COMPLETE ALTERNATOR, REGULATOR AND HARNESS KIT.

PX-3S-305 IS THE ALTERNATOR ONLY PART NUMBER. THIS NUMBERING SYSTEM IS THE SAME WITH ALL MODELS OF PENNTEX KITS AND ALTERNATORS: PX-220/PX-2, PX-420/PX-4, PX-520/PX-5, ETC.

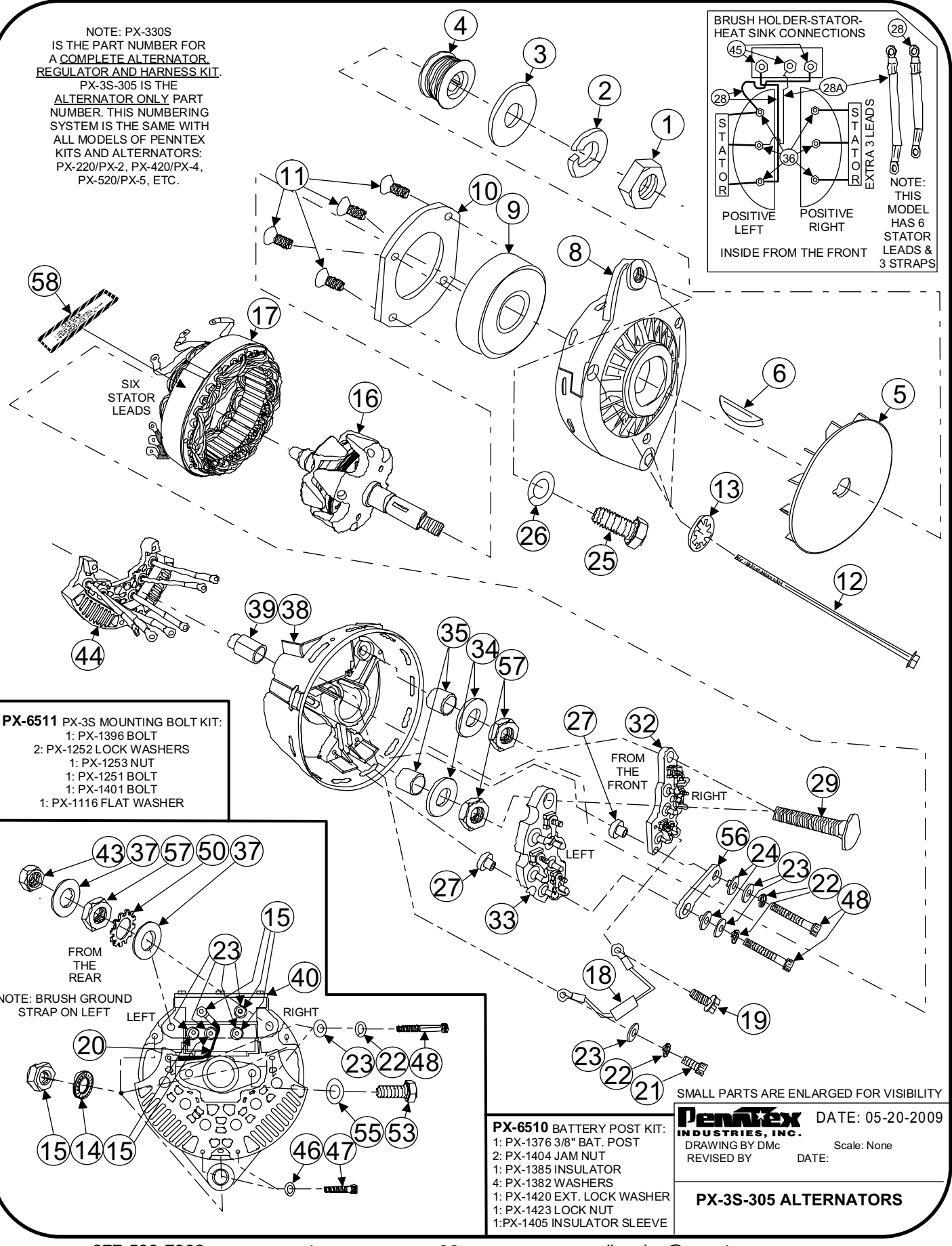
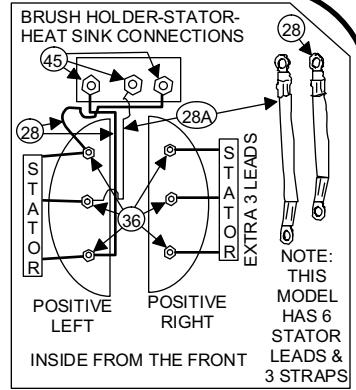

- PX-6511 PX-3S MOUNTING BOLT KIT:**
- 1: PX-1396 BOLT
 - 2: PX-1252 LOCK WASHERS
 - 1: PX-1253 NUT
 - 1: PX-1251 BOLT
 - 1: PX-1401 BOLT
 - 1: PX-1116 FLAT WASHER

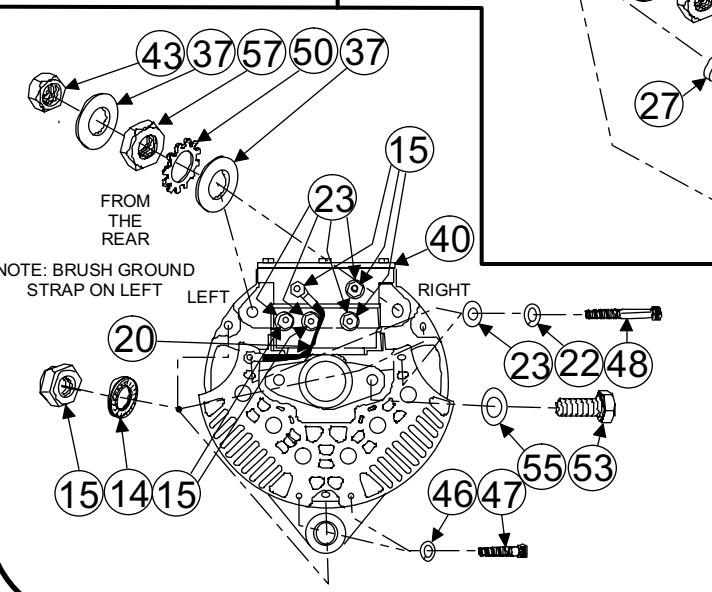

SMALL PARTS ARE ENLARGED FOR VISIBILITY

- PX-6510 BATTERY POST KIT:**
- 1: PX-1376 3/8" BAT. POST
 - 2: PX-1404 JAM NUT
 - 1: PX-1385 INSULATOR
 - 4: PX-1382 WASHERS
 - 1: PX-1420 EXT. LOCK WASHER
 - 1: PX-1423 LOCK NUT
 - 1: PX-1405 INSULATOR SLEEVE

PennTex INDUSTRIES, INC. DATE: 05-20-2009

DRAWING BY Dmc Scale: None

REVISED BY DATE:

PX-3S-305 ALTERNATORS

PX-3S-305**PARTS LIST**

All



No.	Part #	Description	Qty.
1	PX-1083	Nut, Rotor	1
2	PX-1059	Washer, Rotor Lock	1
3	PX-1058	Spacer, Fan	1
4	PX-1355	Pulley, 2.5 K8 LB (PX3)	1
5	PX-1409	Fan, Cooling (PX3&6)	1
6	PX-1080	Key, Woodruff (PX3&6)	1
8	PX-1073	Housing, Front (PX3&6)	1
9	PX-1074	Bearing, Front (PX2/3/4G/5)	1
10	PX-1075	Retainer, Bearing (PX3&6)	1
11	PX-1301	Screw, Front Bearing Retainer	4
12	PX-1092	Bolt, Thru (PX3)	3
13	PX-1101	Washer, #10 Internal Lock	3
14	PX-1269	Washer, #10 Nord Locking	3
15	PX-1213	Nut, 10-32 Nylon Lock	8
16	PX-1077	Rotor, 14V	1
17	PX-5541	Stator, 14V 305A (PX3)	1
18	PX-3514	Capacitor Assembly (PX3)	1
19	PX-1096	Screw, 8-32x3/8" Hex	1
20	PX-3100	Strap, Brush Holder Ground	1
21	PX-1303	Screw, 10-32x1/2" SHC	1
22	PX-1100	Washer, #10 Lock	5
23	PX-1111	Washer, #10 Flat	9
24	PX-1091	Insulator, Shoulder (PX3&6)	2
25	PX-1251	Bolt, 1/2x13x1" Hex Gr 8	1
26	PX-1252	Washer, 1/2" Split Lock Gr 8	1
27	PX-1090	Insulator, Positive Heat Sink	2
28	PX-3510	Strap, Rectifier A/C (PX3&6)	2
28A	PX-3510L	Strap, Rectifier A/C Long (PX3&6)	1
29	PX-1376	Battery Post, 3/8x2-1/2" (PX3)	2
32	PX-6504	Heat Sink Asm, Pos R (PX3)	1
33	PX-3504	Heat Sink Asm, Pos L (PX3)	1
34	PX-1385	Insulator, Heat Sink 3/8" (PX3)	2
35	PX-1405	Sleeve, 3/8" Battery Post (PX3)	2
36	PX-1099	Nut, 8-32 Keps	6
37	PX-1382	Washer, 3/8" Flat (PX3&6)	4
38	PX-1375	Housing, Rear (PX3&6)	1
39	PX-1081	Bearing, Rear (INA)	1
40	PX-3517	Brush Assembly, New (PX3&6)	1
43	PX-1423	Nut, 3/8" Steel Lock	2
44	PX-6506	Heat Sink Asm, Neg Ext (PX3)	1

No.	Part #	Description	Qty.
45	PX-1113	Nut, 10-32 Keps	3
46	PX-1104	Washer, 1/4" Lock	2
47	PX-1380	Bolt, 1/4-20x1-1/2" SHC	2
48	PX-1377	Screw, 10-32x1-1/4" SHC	4
50	PX-1420	Washer, 3/8" External Lock	2
53	PX-1401	Screw, 5/16x3/4" Cap	1
55	PX-1116	Washer, 5/16" Flat	1
56	PX-1386	Strap, Positive Heat Sink	1
57	PX-1404	Nut, 3/8" Steel Jam	4
58	PX-1387	Decal, Caution (PX3&6)	1
***	PX-6510	Battery Post Kit	2
***	PX-6511	Mounting Bolt Kit (PX3S)	1
***	PX-3513	Hsg Asm, Rear W/O Stator	1
***		Not Shown In Drawing	
		NOTE: A PX-3S-305 uses a PX-4000 Voltage Regulator and a PX-3502-3 Harness.	
		Contact Us: Phone: 817-590-2818 Fax: 817-590-0505 web: www.penntexusa.com email: sales@penntexusa.com	
		PennTex 05-18-09	